

| | |
|---|---------|
| | |
| Phoenix 2 Duo (P2-15W with Elite 6x4 chassis) | |
| Overall Length | 11.200m |
| Overall Width | 2.530m |
| Overall Body Height | 3.751m |
| Min Body Ground Clearance | 0.304m |
| Track Width | 2.500m |
| Lock to Lock Time | 4.00s |
| Kerb to Kerb Turning Radius | 9.500m |

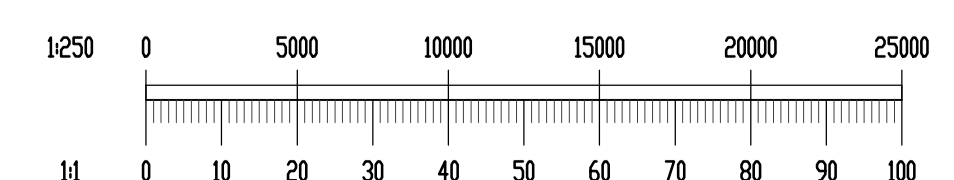
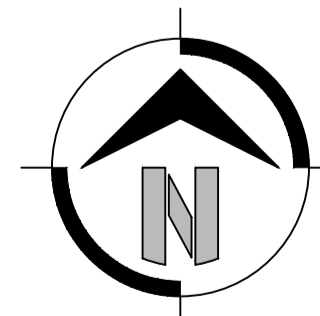
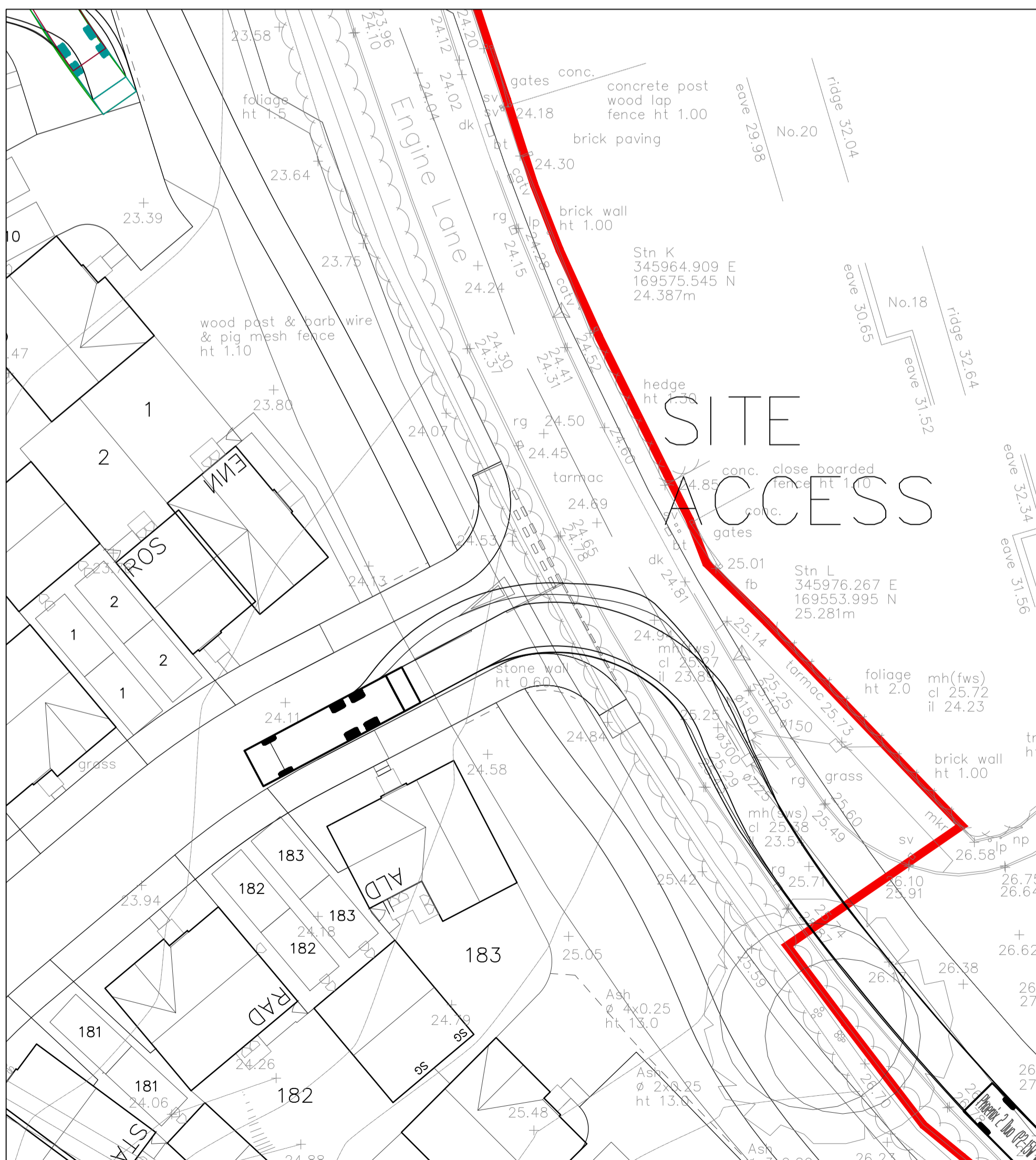

| Rev | Date | Description | By |
|-----|------|-------------|----|
| | | | |

Dimensions to be verified on site.
This drawing should not be scaled. Use figured dimensions only.
Any discrepancies should be referred to the Engineer prior to work being put in hand.
This drawing is copyright.

QuadConsult Limited
 Columbus House, Village Way
 Greenmeadow Business Park
 Cardiff
 CF15 7NE
 029 2077 9844
 contactus@quadconsult.co.uk
 www.quadconsult.co.uk

Project: Engine Lane, Nailsea.
 Title: AutoTracking Junctions Sheet 1 of 5

| | | | | |
|---------------------------------|----------|------------|-------|-----------------|
| Drawing Status: PLANNING | | | | |
| Designed by | Drawn by | Checked by | Date | Scale @ A1 size |
| RWP | RWP | SM | Mar17 | 1:250 |
| Project No | | Drawing No | | Revision |
| 17014 | | C-PL102-01 | | 0 |

File name: 17014_CPL102_AutoTracking.dwg