

**SITE LOCATION PLAN (1:5000)**

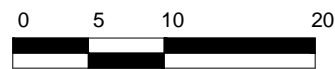

**DETAIL 1 (1:500)**

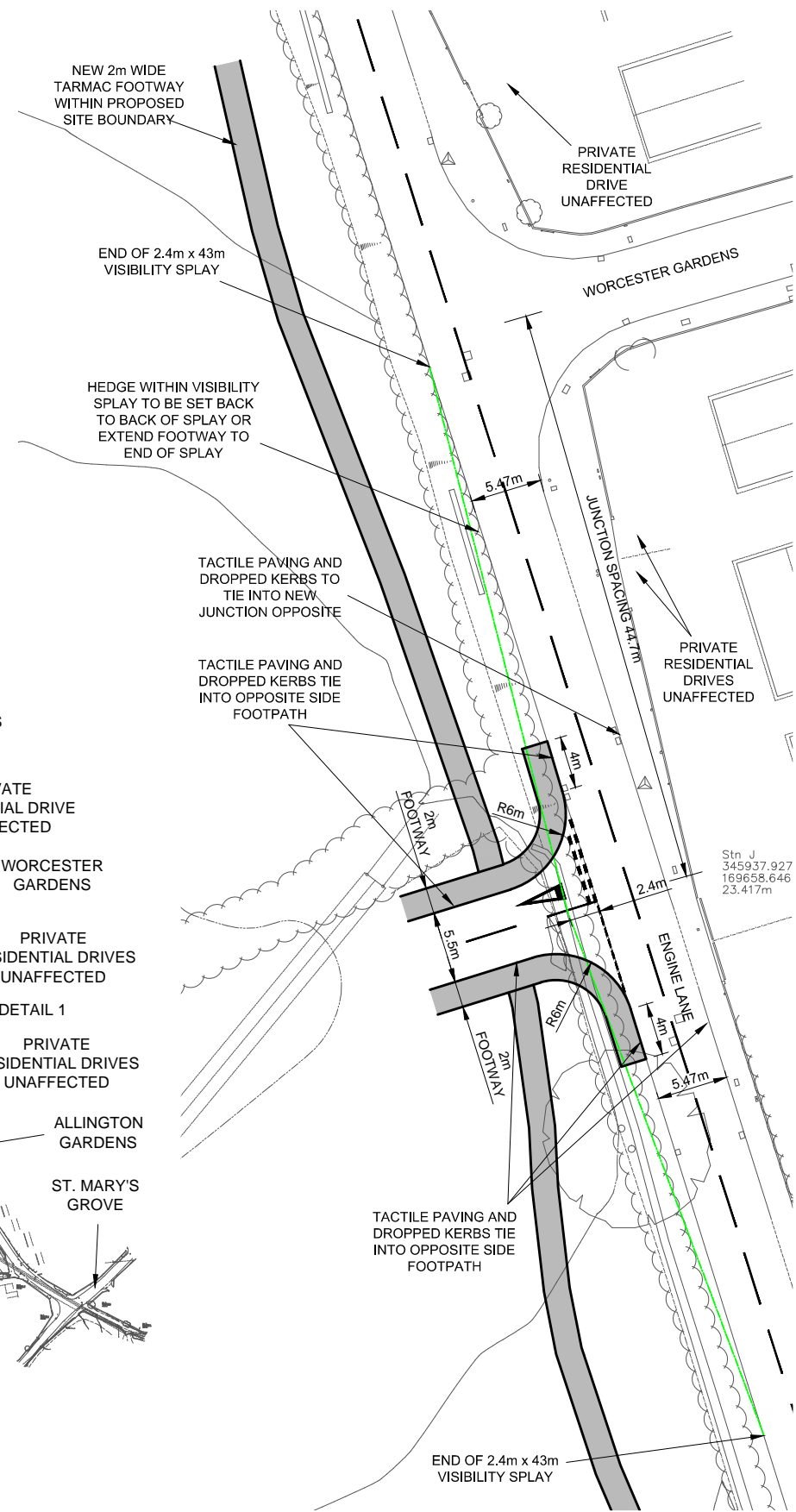
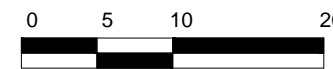
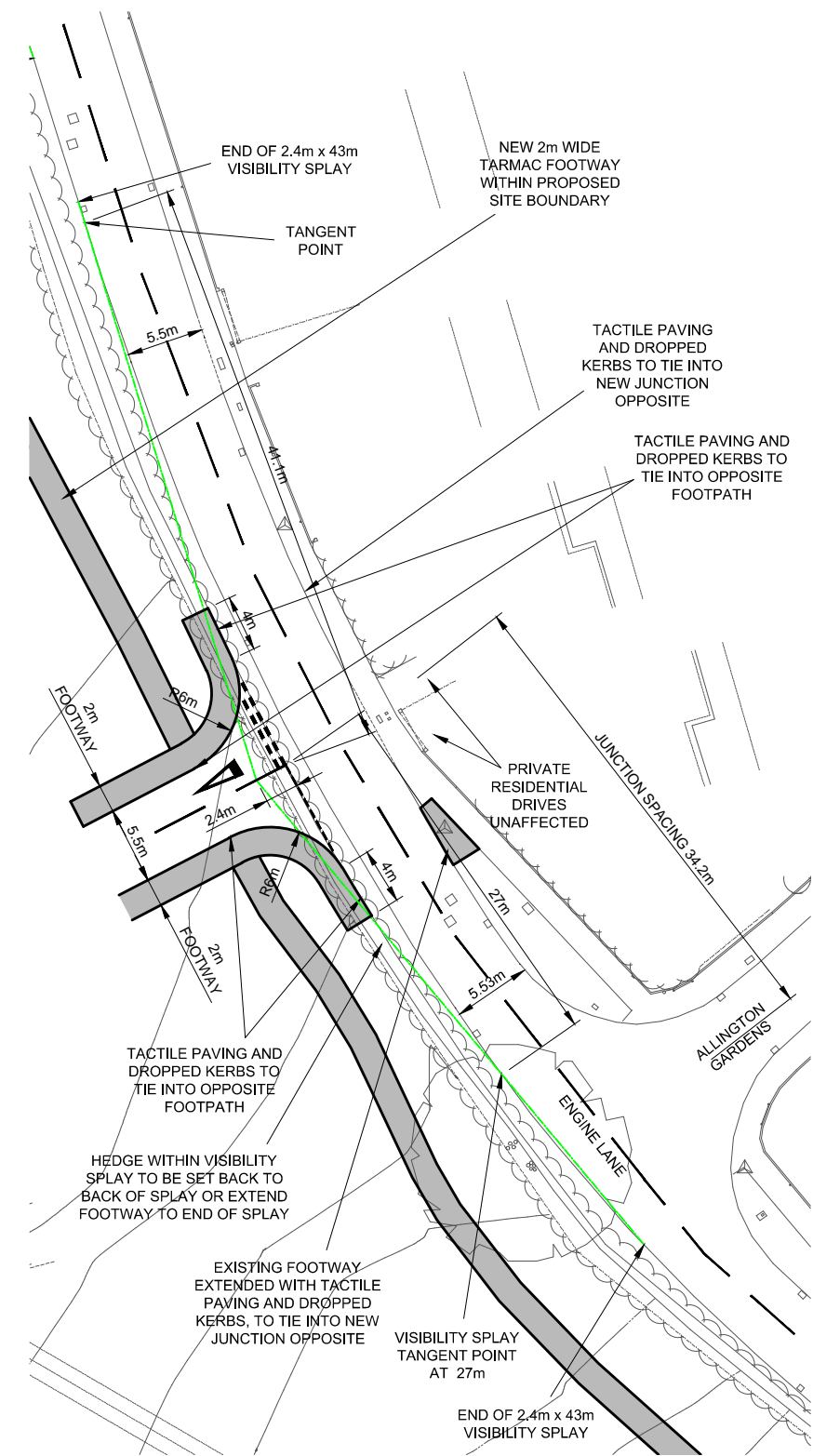

**DETAIL 2 (1:500)**

**NOTES**

- 1) Base taken from Anthony Brookes Surveys Ltd drawings 371/8832/1A & 371/8832/1B
- 2) Subject to detailed design

C	Footways adjusted to reflect masterplan	AL	MB	03/17
B	Access adjusted to reflect masterplan	AL	MB	03/17
A	Access adjusted to reflect masterplan	AL	MB	08/16
0	Original Issue	AL	MB	02/16
Rev	Revision	Drn	App	Date

**MBC**  
 Mark Baker Consulting Ltd  
 32 MONPELIER COURT  
 STATION ROAD  
 MONPELIER  
 BRISTOL BS6 5EE  
 TEL : (0117) 924 6994  
 FAX : (0117) 924 6156  
 mbc.traffic@virgin.net  
 traffic engineers & transport planners

Client  
**BARRATT HOMES  
 (BRISTOL DIVISION)**

Project  
**LAND WEST OF ENGINE LANE,  
 NAILSEA**

Title  
**PROPOSED SITE ACCESSES**

Drawn	Checked	Approved	Date
AL	MB	MB	15/02/2016

Scales 1:5000 & 500 @ A3

CAD Ref	Plot	Drawing No.	Rev
		10144/200	C